

SNO-WAY®

SNOW & ICE CONTROL EQUIPMENT

WIRING DIAGRAM AND INSTALLATION INSTRUCTIONS

**FOR 99101110 OR 99101151
ADAPTER KIT**

Sno-Way®, Down Pressure® and EIS® are registered trademarks of Sno-Way International, Inc.
ProControl™, MegaBlade™, V-Wing™, E-Z Switch™, Revolution™, MaxAdjust™, SpeedLock™, and QuickJack™
are trademarks of Sno-Way International, Inc.

©2015 Sno-Way® International

97101832C

WIRING DIAGRAM



1. THINK SAFETY, ALWAYS WEAR SAFETY GLASSES WHEN PERFORMING THE OPERATIONS PRESCRIBED IN THESE INSTRUCTIONS
2. READ ALL INSTRUCTIONS CAREFULLY BEFORE ATTEMPTING INSTALLATION

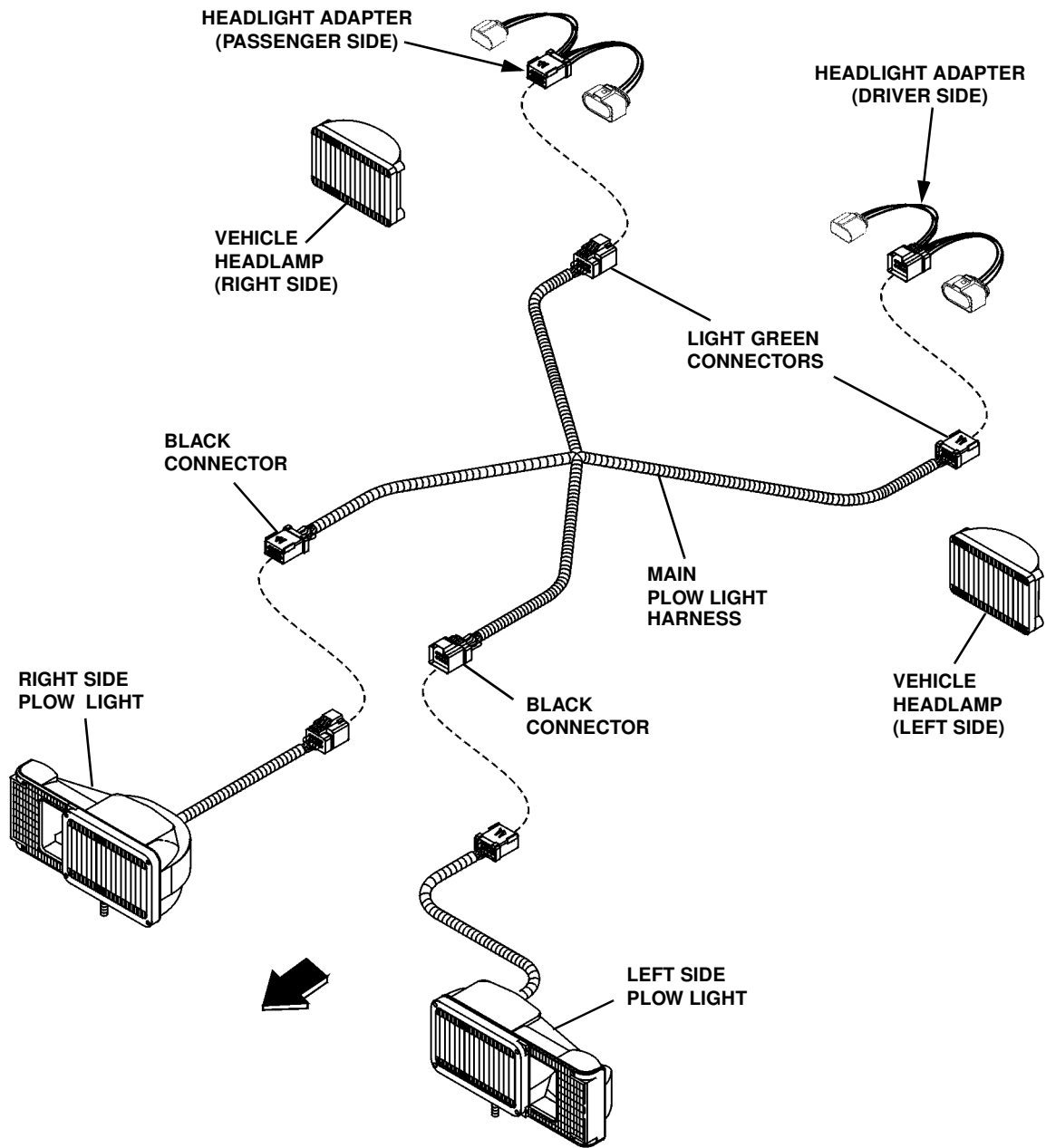
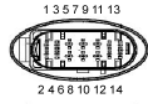

Figure 1

ADAPTER KIT 99101110

Headlight Adapter Schematic - Female (96115075) (Driver's Side)

MALE CONNECTOR LAYOUT	
CAVITY POSITION	WIRE COLOR / PLUG
1	BLACK WITH WHITE STRIPE
2	BROWN
3	EMPTY
4	BLACK WITH YELLOW STRIPE
5	GREEN
6	EMPTY
7	BLUE
8	EMPTY
9	WHITE
10	EMPTY
11	EMPTY
12	YELLOW
13	BLACK
14	RED WITH BLACK STRIPE



MALE CONNECTOR



FEMALE CONNECTOR

FEMALE CONNECTOR



FEMALE CONNECTOR LAYOUT	
CAVITY POSITION	WIRE COLOR / PLUG
1	BLACK WITH WHITE STRIPE
2	TAN
3	1.5mm PLUG
4	BLACK WITH YELLOW STRIPE
5	LT GREEN
6	2.8mm PLUG
7	LT BLUE
8	2.8mm PLUG
9	WHITE
10	2.8mm PLUG
11	1.5mm PLUG
12	ORANGE
13	BLACK
14	RED WITH BLACK STRIPE

Figure 2

Headlight Adapter Schematic - Male (96115076) (Passenger's Side)

MALE CONNECTOR LAYOUT	
CAVITY POSITION	WIRE COLOR / PLUG
1	BLACK WITH WHITE STRIPE
2	BROWN
3	EMPTY
4	BLACK WITH YELLOW STRIPE
5	GREEN
6	EMPTY
7	BLUE
8	EMPTY
9	WHITE
10	EMPTY
11	EMPTY
12	GRAY
13	BLACK
14	RED WITH BLACK STRIPE

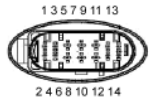

MALE CONNECTOR



FEMALE CONNECTOR

MALE CONNECTOR

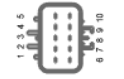

FEMALE CONNECTOR LAYOUT	
CAVITY POSITION	WIRE COLOR / PLUG
1	BLACK WITH WHITE STRIPE
2	PINK
3	1.5mm PLUG
4	BLACK WITH YELLOW STRIPE
5	LT GREEN
6	2.8mm PLUG
7	LT BLUE
8	2.8mm PLUG
9	WHITE
10	2.8mm PLUG
11	1.5mm PLUG
12	VIOLET
13	BLACK
14	RED WITH BLACK STRIPE

Figure 3

ADAPTER KIT 99101151

Headlight Adapter Schematic - Female (96115421) (Driver's Side)

MALE CONNECTOR LAYOUT	
CAVITY POSITION	WIRE COLOR / PLUG
1	BLACK WITH WHITE STRIPE
2	BROWN
3	EMPTY
4	BLACK WITH YELLOW STRIPE
5	GREEN
6	EMPTY
7	BLUE
8	EMPTY
9	WHITE
10	EMPTY
11	EMPTY
12	YELLOW
13	BLACK
14	RED WITH BLACK STRIPE

FEMALE CONNECTOR LAYOUT	
CAVITY POSITION	WIRE COLOR / PLUG
1	BLACK WITH WHITE STRIPE
2	BROWN
3	1.5mm PLUG
4	BLACK WITH YELLOW STRIPE
5	LT GREEN
6	2.8mm PLUG
7	LT BLUE
8	2.8mm PLUG
9	WHITE
10	2.8mm PLUG
11	1.5mm PLUG
12	YELLOW
13	BLACK
14	RED WITH BLACK STRIPE

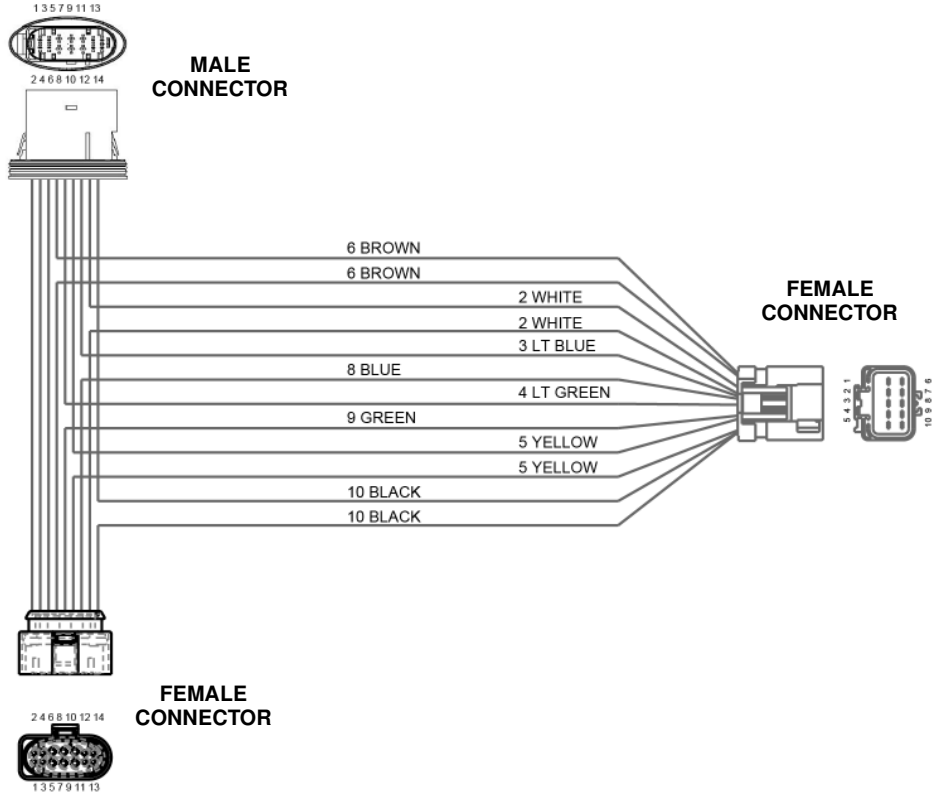

Figure 4

Headlight Adapter Schematic - Male (96115422) (Passenger's Side)

MALE CONNECTOR LAYOUT	
CAVITY POSITION	WIRE COLOR / PLUG
1	BLACK WITH WHITE STRIPE
2	BROWN
3	EMPTY
4	BLACK WITH YELLOW STRIPE
5	GREEN
6	EMPTY
7	BLUE
8	EMPTY
9	WHITE
10	EMPTY
11	EMPTY
12	GRAY
13	BLACK
14	RED WITH BLACK STRIPE

FEMALE CONNECTOR LAYOUT	
CAVITY POSITION	WIRE COLOR / PLUG
1	BLACK WITH WHITE STRIPE
2	BROWN
3	1.5mm PLUG
4	BLACK WITH YELLOW STRIPE
5	LT GREEN
6	2.8mm PLUG
7	LT BLUE
8	2.8mm PLUG
9	WHITE
10	2.8mm PLUG
11	1.5mm PLUG
12	GRAY
13	BLACK
14	RED WITH BLACK STRIPE

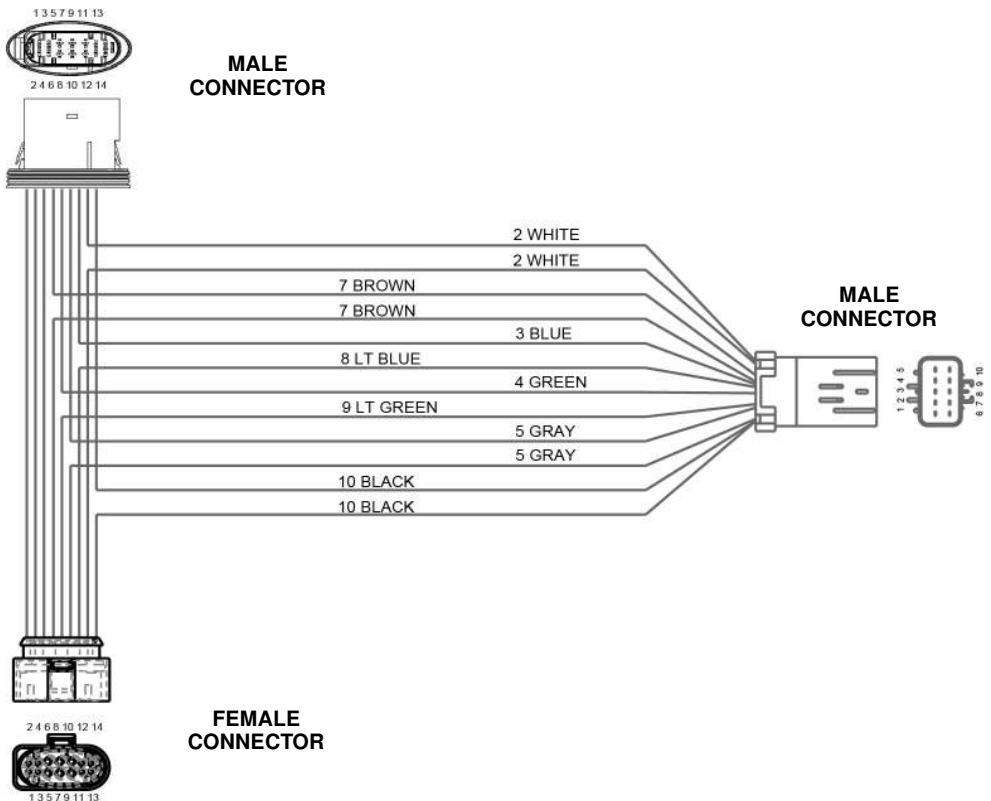

Figure 5

ADAPTER KIT INSTALLATION (Refer to Wiring Diagram and Harness Schematics for Kit Purchased)

IMPORTANT: With vehicle and all lights and accessories off, apply a dielectric compound on all electrical connections to prevent corrosion.

1. Disconnect the Negative terminal from the battery or batteries.
2. Disconnect the vehicle headlight electrical connectors from the back of the vehicle headlamps.

NOTE: In order to disconnect some vehicle headlight connectors, it may be necessary to remove the headlamp assembly from the front of the vehicle, if the connector is not easily accessible.

3. Plug together the light green connectors on the main harness with the corresponding adapters needed for the vehicle. The driver's side connection has a yellow wire and the passenger side has a gray wire.

IMPORTANT: The correct adapters must be connected to each side for proper function.

4. Plug the headlight adapters into the vehicle on both sides. Plug the corresponding connectors into the back of the vehicle headlights, then the connectors from the vehicle headlights into the corresponding connectors on the headlight adapter.

NOTE: These specific headlight adapter connectors are known to be difficult to fully engage. Without full engagement, corrosion and incomplete connections can occur.

With the release tab of the female connector being pushed forward towards the male connector (See Figure 6), push both connectors together until an audible click is heard (See Figure 7). Once the audible click is heard, the connectors will be fully engaged.

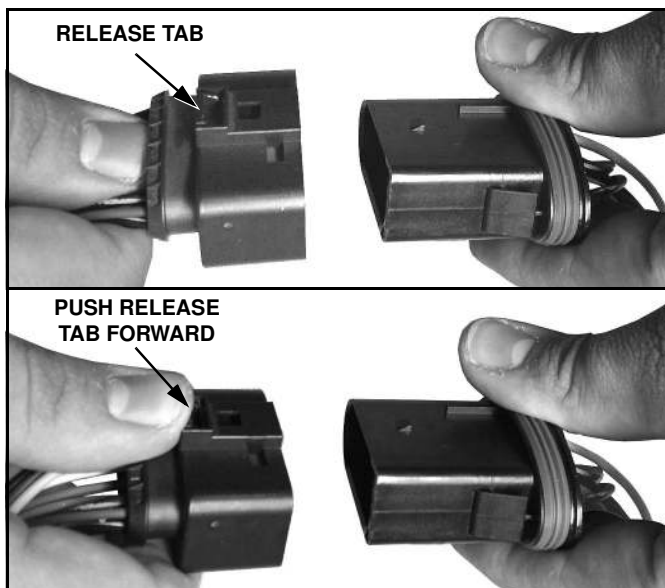

Figure 6

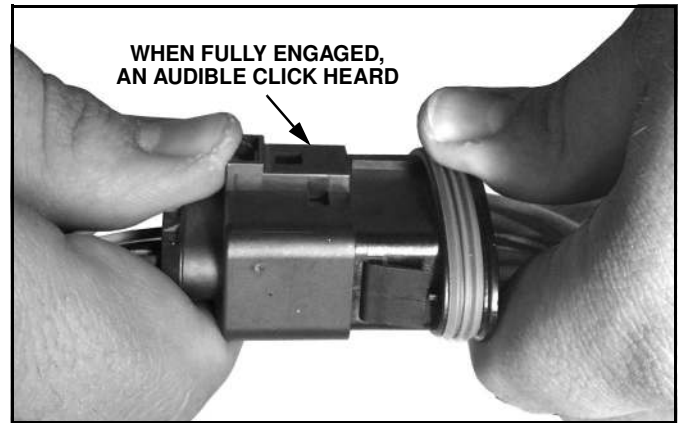

Figure 7

5. Place the other end of the main harness on the outside of the grille.
6. Attach the Negative battery terminal removed in step 1.
7. Attach the main harness connectors to the right and left plow light headlamps. Turn on the vehicle lights and check operation. Check to make sure the vehicle headlights go out and plow headlights come on. Check park and turn signals.
8. If disassembled, reassemble vehicle components.
9. Secure the main harness to a safe location with electricians tape or plastic wire ties. Excess harness length should be neatly coiled and taped, or tied up out of the way.



CAUTION

Make sure that wire harness is routed away from all moving engine components.
Example; fan, belts etc.
DO NOT attach wire harness to hoses, radiator AC coils, exhaust manifolds, or control cables.

NOTES

NOTES

SNO-WAY® INTERNATIONAL, INC.



Hartford, WI 53027 USA
Website: www.snoway.com
©2015 Sno-Way® International