

SNO-WAY®

SNOW & ICE CONTROL EQUIPMENT

INSTALLATION INSTRUCTIONS

4-SIGHT SYSTEM KIT - EIS ONLY
99100969

Sno-Way®. Down Pressure® and EIS® are registered trademarks of Sno-Way International, Inc.
ProControl™, MegaBlade™, V-Wing™, E-Z Switch™, Revolution™, MaxAdjust™, SpeedLock™, and QuickJack™ are
trademarks of Sno-Way International, Inc.

©2013 Sno-Way® International

97101522D



**1. THINK SAFETY, ALWAYS WEAR SAFETY GLASSES WHEN PERFORMING THE OPERATIONS
PRESCRIBED IN THESE INSTRUCTIONS**

2. READ ALL INSTRUCTIONS CAREFULLY BEFORE ATTEMPTING INSTALLATION



Determine if the plow light harness needs to be modified to accept the 4-Sight harness. Look at both the driver and passenger side plow light harness. If there are wires wrapped inside the loom with male push-on terminals, proceed to step 5 in the following instructions. If there are not any additional wires within the harness, proceed to step 1.

NOTE: Some vehicles equipped with HID lights may require modification to plow light harness. If your truck is equipped with a single bulb single filament bulb:

a) The light blue wire on the PLOW light harness should be moved from pin location 8 to 9 on the MALE connector. (See Fig. 1).

b) The light blue wire on the PLOW light harness should be moved from pin location 3 to 4 on the FEMALE connector. (See Fig. 2)

ADAPTER WIRE INSTALLATION

1. Remove pin locks from the black male and female connectors on plow lamps. **Note:** Lock is red on male connector and blue on female connector.

2. Remove white cavity plug from pin cavity 8 and then insert light blue wire with male terminal into pin 8 of the male connector (See Figure 1.).

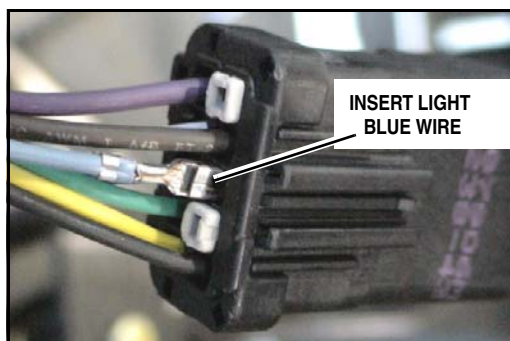

Figure 1

3. Remove the white cavity plug from pin cavity 3 and then insert light blue wire with female terminal into pin 3 of the female connector (See Figure 2.).

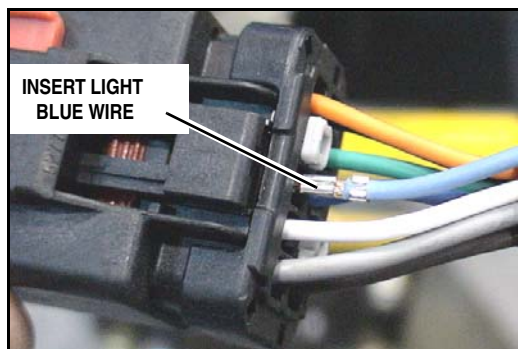

Figure 2

4. Remove or cut off female push pin connector from the brown wire of the 4-Sight harness.

5. Using Scotchlok™ provided and at a suitable distance, tap onto the brown wire (pin 7) of the male connector on driver side EIS lamp harness with the brown wire from 4-Sight System harness. After completing this step, you have located the brown wire referenced in the next step.

6. Locate the brown and light blue wires with male push-on terminals within the driver side (DS) plow light harness. Locate the light blue wire with a male terminal within the passenger side (PS) plow light harness.

7. Connect the female terminals from the 4-Sight harness to the matching colored wires on both the driver (DS) and passenger (PS) plow light harness.

8. Route the 4-Sight wire down Driver side lightbar upright, securing the wires within the rose bud clips that secure the plow light harness to the lightbar (See Figure 3.).

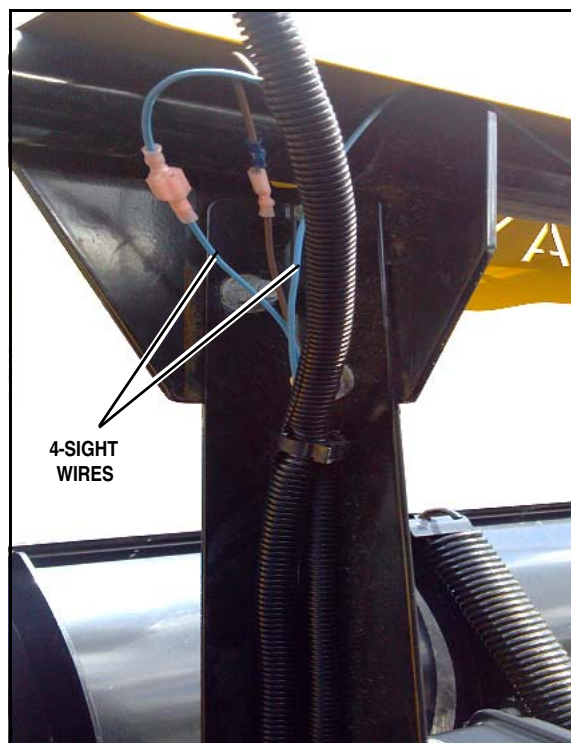

Figure 3

9. Route the 4-Sight harness through the power wire clamp along the driver side (DS) of the A-frame (See Figure 4.).



Figure 4

10. Under the pump cover, disconnect blue/white wire from B (Float/DP) coil; insert blue/white wire with male terminal from the 4-site harness into the female terminal attached to blue/white wire (See Figure 5.).

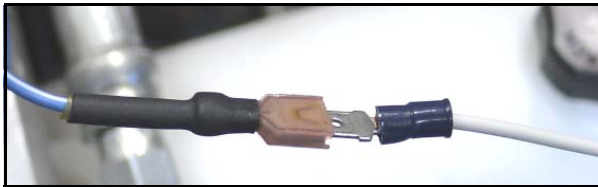

Figure 5

11. Connect white wire with female terminal to B (Float/DP) coil blue/white wire.

12. Determine if the vehicle is power or ground switching.

a. If it is **power switching** connect ring terminal attached to red wire to the power side of the solenoid post (See Figure 6.).

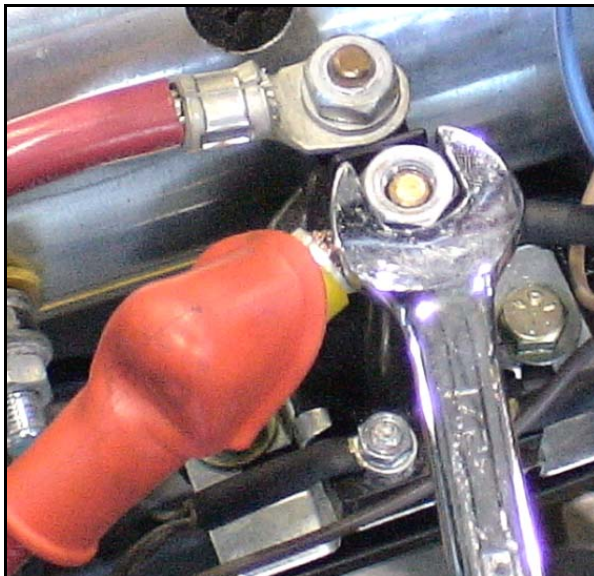

Figure 6

b. If it is **ground switching**, connect ring terminal to valve manifold ground (See Figure 7.).

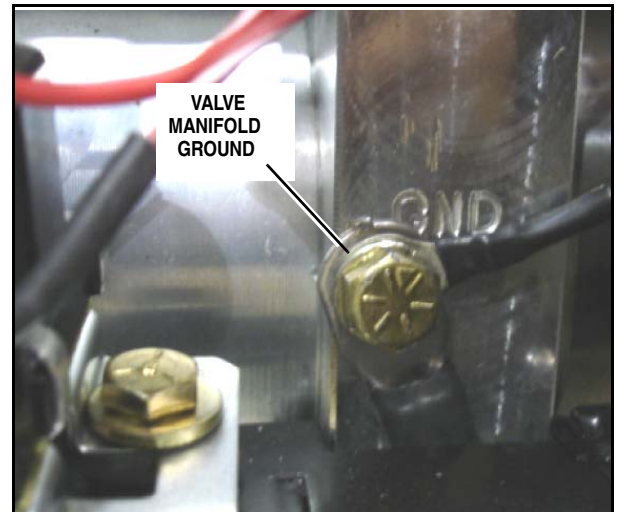

Figure 7

13. Verify operation of 4-Sight System.

NOTE: Two conditions must be met for the 4-Sight System to work; the plow must be while in float or down pressure and the park lamps must be on. When these conditions are met, the truck high beams will illuminate.

14. Secure loose wires (See Figure 8.). Operate plow through all functions to verify wire routing. Re-route any wires that could be pinched or damaged and re-install pin locks removed in step 1 to complete installation.



Figure 8

PARTS LIST

ITEM	PART NO.	DESCRIPTION	QTY.
1	----	Harness, 4-Sight Plow Side.....	1
2	----	Connector, Splice Tap	1
3	----	Harness, 4-Sight, RH Plow.....	1
4	----	Harness, 4-Sight, LH Plow	1
5	96114448	Relay, 50 AMP, SPST, Mini.....	1

SNO-WAY® INTERNATIONAL, INC.



Hartford, WI 53027 USA
Website: www.snoway.com
©2013 Sno-Way® International