

# **SNO-WAY**®

**SNOW & ICE CONTROL EQUIPMENT**

## **ASSEMBLY & INSTALLATION INSTRUCTIONS**

**VEHICLE MOUNT KIT 99100936**  
**FOR 22 PLOW SERIES ONLY**  
**(Includes Vehicle Center Member)**

TO FIT

**2007 Jeep Wrangler, Unlimited and Rubicon (4x4)**



Sno-Way® and EIS® are registered trademarks and Down Pressure™ is a trademark of Sno-Way International, Inc.



1. **THINK SAFETY, ALWAYS WEAR SAFETY GLASSES WHEN PERFORMING THE OPERATIONS PRESCRIBED IN THESE INSTRUCTIONS**
2. **READ ALL INSTRUCTIONS CAREFULLY BEFORE ATTEMPTING INSTALLATION**
3. **BEFORE BEGINNING WORK MAKE SURE TO SET PARKING BRAKE AND CHOCK WHEELS**



### MINIMUM VEHICLE RECOMMENDATIONS

Heavy Duty Alternator  
 Heavy Duty Battery  
 Manufacturers Snowplow Package

### ASSEMBLY TOOLS NEEDED

|                  |  |
|------------------|--|
| Drill Bits       | 17/32"                                       |
| Impact Sockets   | 7/16" – 1-3/8"                               |
| Wrenches         | 10mm – 18mm<br>7/16" – 1-3/8"<br>10mm – 18mm |
| Torque Wrench    |  |
| Rat Tail Pry Bar |  |

*NOTE: On some vehicles it may be necessary to use a form of load booster to decrease the vehicle's front suspension sag with the snow plow in place. This can be accomplished with the use of supplementary air bags, booster springs, or similar load boosting devices. Since there are different load boosting devices available, it will up to the customer/end user to decide and purchase the product to suit the application, and not the responsibility of Sno-Way International, Inc.*

### INSTALLATION NOTES

1. **Unless otherwise specified, mount all Vehicle Mount Kit Components to vehicle before tightening any hardware.**
2. **It is recommended that LOCTITE®, or similar thread locking product, be used on ALL mounting hardware (i.e. Nuts, Cap Screws, Bolts, etc.).**
3. Vehicle should be parked on a level surface with a normal vehicle load on the FRONT suspension.
4. Items in parentheses ( ) refer to quantity required for this step. Items in parentheses with a pound sign (#) indicate the part number as found in the parts list on the last page of this document.  
Example: (10) Washer, Lock, 1/2" (#8).
5. It maybe necessary to relocate license plate holder. Check state and local laws for placement, if needed.

5. Repeat steps 3 and 4 to install (1) Side Weldment, RH (#3).
6. Reinstall the sway bar using the existing hardware, ensuring that the horizontal plate that runs along the under side of the frame rail is sandwiched between the bottom of the frame and the sway bar brackets.

### MOUNTING INSTRUCTIONS

1. Remove the air dam and the bumper. Retain all fasteners for later reinstallation.
2. Remove the hardware that holds the sway bar to the vehicle and retain the hardware to reinstall the brackets in a later step.
3. Install (1) Side Weldment, LH (#2). Insert the end of the blocker beam through the large square cut in the Side Weldment, LH. Align the slot in the Side Weldment with the bottom hole in the blocker beam brackets. Insert (1) Handle Bolt 1/2" x 1-1/4" x 6" (#4) and (1) 1/2" Flat Washer (#7) into the truck frame through the holes. Attach with (1) 1/2" Flat Washer (#7) and (1) 1/2" Nylock Nut (#9) and finger tighten.
4. Insert (2) 1/2"-13 x 1-1/2" Cap Screws (#6) with (2) 1/2" Flat Washers (#7) into frames blocker beam and through the slots in the horizontal piece on the Side Weldment. Attach using (2) 1/2" Flat Washers (#7) and (2) 1/2" Nylock Nuts (#9) and finger tighten.

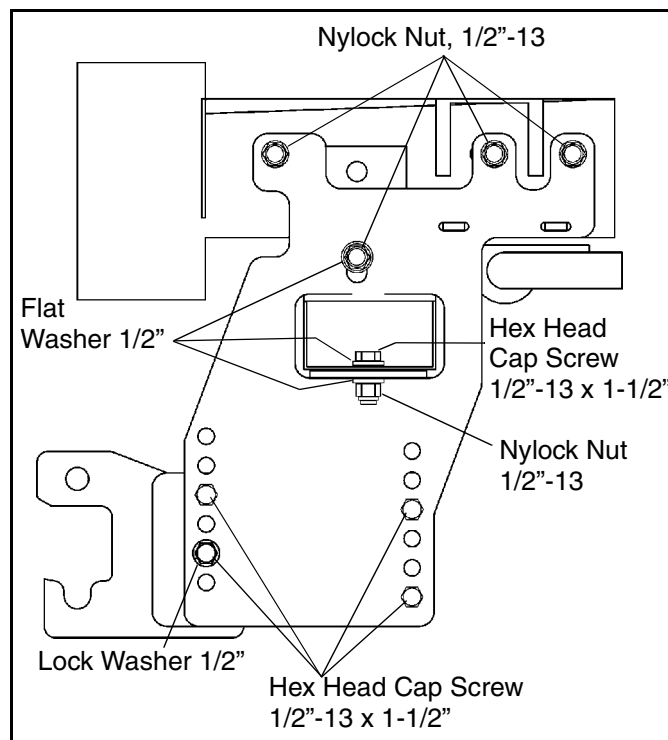

Figure 1

7. Using the 3 holes in the Side Weldments as guides, drill (6) 17/32" holes through the outside of the frame rails. For the 4 rear holes insert (4) 2 per side 1/2"-13 x 2" x 16" Handle Bolts (#5) into the front of the frame rail with (4) 1/2" Flat Washers (#7) on each handle bolt. Attach using (4) 1/2" Nylock Nuts (#9) and finger tighten. In the front hole on both the Side Weldments, LH and RH secure using (1) each per side 1/2"-13 x 2"

Cap Screws (#10), 1/2" Flat Washers (#7) and 1/2" Nylock Nuts (#9) and finger tighten.

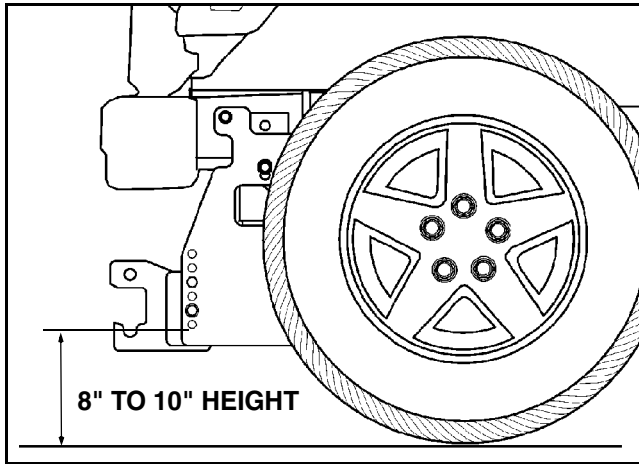

Figure 2

**IMPORTANT: Height from the center of the lower Plow Mounting holes on the Vehicle Mount Kit to the ground should be between 8" and 10" to ensure proper operation.**

8. Tighten all hardware using the torque specification chart provided.
9. Reinstall the bumper using the original hardware. Air dam can be reinstalled, but there are major modifications needed, so up to installer to decide if modifications are warranted or wanted.

| TORQUE SPECIFICATIONS FOR STANDARD MACHINE HARDWARE |          |          |          |             |            |
|---|----------|----------|----------|-------------|------------|
| Bolt Size   | GR.2 Dry | GR.5 Dry | GR.8 Dry | Metric Size | GR.8.8 Dry |
| 1/4"  | 66*      | 9        | 12       | M8          | 17         |
| 5/16"   | 11       | 17       | 25       | M10         | 35         |
| 3/8"  | 20       | 30       | 45       | M12         | 60         |
| 7/16"   | 32       | 50       | 70       | M14         | 95         |
| 1/2"  | 50       | 75       | 110      | M16         | 155        |
| 9/16"   | 70       | 110      | 150      |             |            |
| 5/8"  | 100      | 150      | 220      |             |            |
| 3/4"  | 175      | 260      | 380      |             |            |
| 7/8"  | 170      | 430      | 600      |             |            |
| 1"  | 250      | 640      | 900      |             |            |

Note: These torque values are to be used for all hardware. Unless otherwise specified, all torque values must meet this specification.  
 Note: All torque values are in Ft.-Lbs unless otherwise stated  
 Note: \*In-Lbs

**REMEMBER After 5 to 10 hours of snowplow usage, re-torque all Cap Screws!**

# PARTS LIST

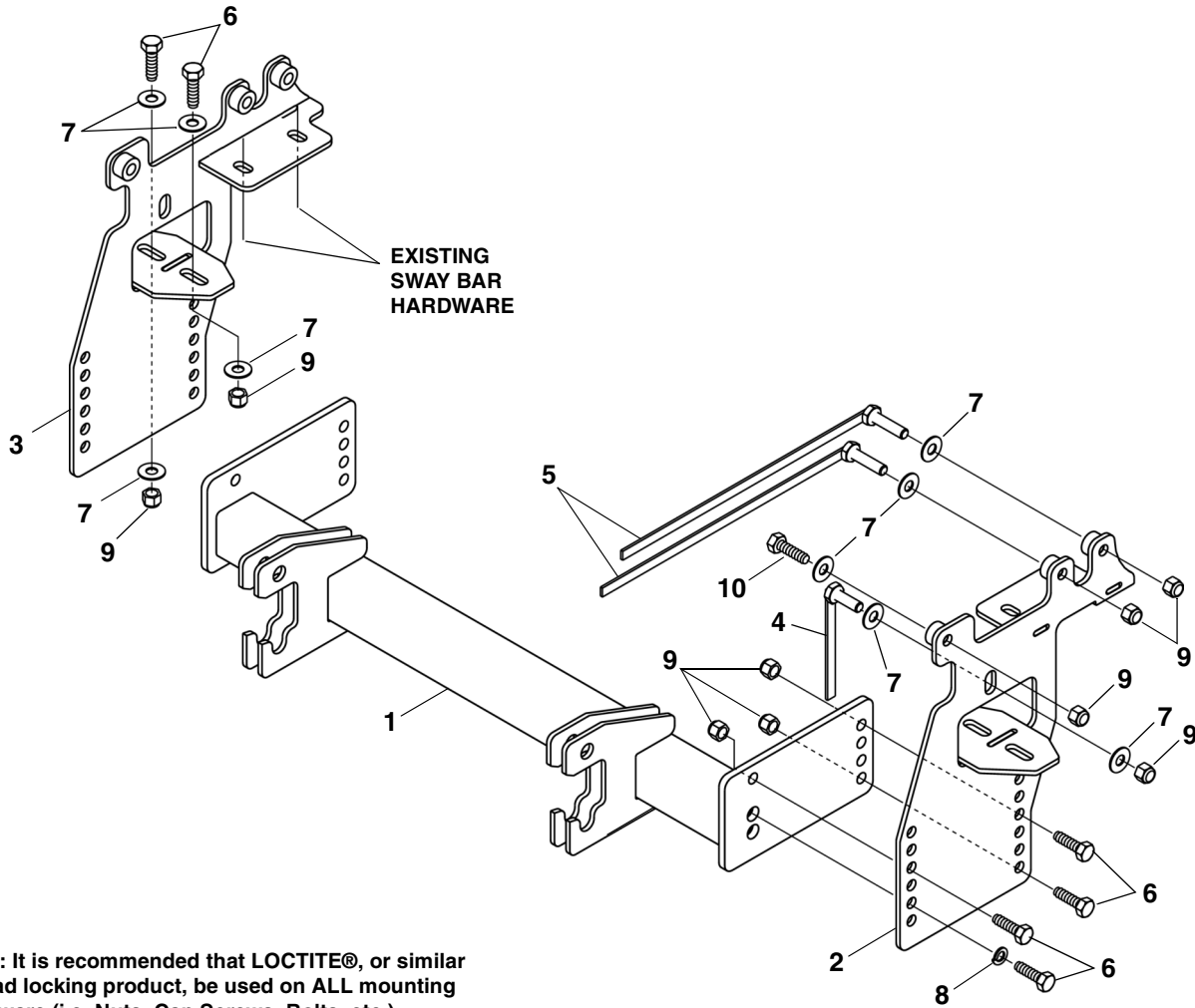

Note: It is recommended that LOCTITE®, or similar thread locking product, be used on ALL mounting hardware (i.e. Nuts, Cap Screws, Bolts, etc.).

| ITEM | PART NO.  | DESCRIPTION                                | QTY. |
|------|-----------|--|------|
| 1    | 96110287* | Vehicle Center Member.....                 | 1    |
| 2    | 96110297* | Side Weldment, LH.....                     | 1    |
| 3    | 96110298* | Side Weldment, RH.....                     | 1    |
| 4    | 96110511* | Handle Bolt, 1/2"-13 x 1-1/4" x 6".....    | 2    |
| 5    | 96110514* | Handle Bolt, 1/2"-13 x 2" x 16".....       | 4    |
| 6    | 98009010  | Cap Screw, Hex Head, 1/2"-13 x 1-1/2"..... | 12   |
| 7    | 98009011  | Washer, Flat, 1/2".....                    | 18   |
| 8    | 98009012  | Washer, Lock, 1/2".....                    | 2    |
| 9    | 98009013  | Nut, Nylock, 1/2"-13.....                  | 18   |
| 10   | 98100094  | Cap Screw, Hex Head, 1/2"-13 x 2".....     | 2    |

\* Not Available As a Service Part

SNO-WAY® INTERNATIONAL, INC.



Hartford, WI 53027 USA  
 Website: [www.snoway.com](http://www.snoway.com)  
 ©2008 Sno-Way® International